



# Lee's Summit School District

## Real World Learning Strategic Plan



## Lee's Summit RVII School District

Mission: To Prepare Each Student For Success In Life

# District Alignment

## Board of Education Priorities



**Board Priority 1:** Increase the achievement of every child through a continued focus on innovative practices, student well-being, and equity in program design and implementation.



**Board Priority 2:** Ensure equitable access to future ready learning environments by further engaging stakeholders in the continued implementation of the Comprehensive Facility Master Plan by identifying PreK-12 facility projects in anticipation of an April 2020 “no tax increase” bond issue.

# District Alignment

## Comprehensive School Improvement Goals



**CSIP Goal I:** Each student will be provided a personalized learning experience that creates student ownership of learning thereby demonstrating growth in student achievement as evidenced by local, state, and national norm comparisons.



**CSIP Goal II:** The District will increase student connectedness and engagement to the school experience as measured by student participation.

# Vision: Portrait of a Graduate

## Portrait of a Graduate



District Alignment: PreK-12 Vision

EXPLORE

IGNITE

EXPERIENCE

# District Alignment: PreK-12 Vision

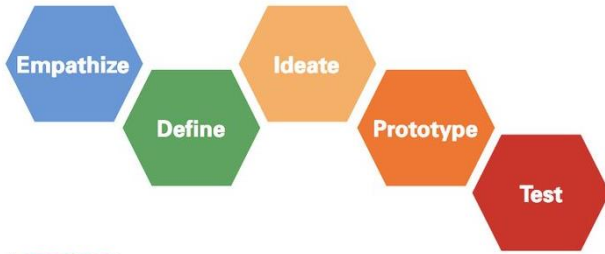

d.   
HASSO PLATTNER  
Institute of Design at Stanford

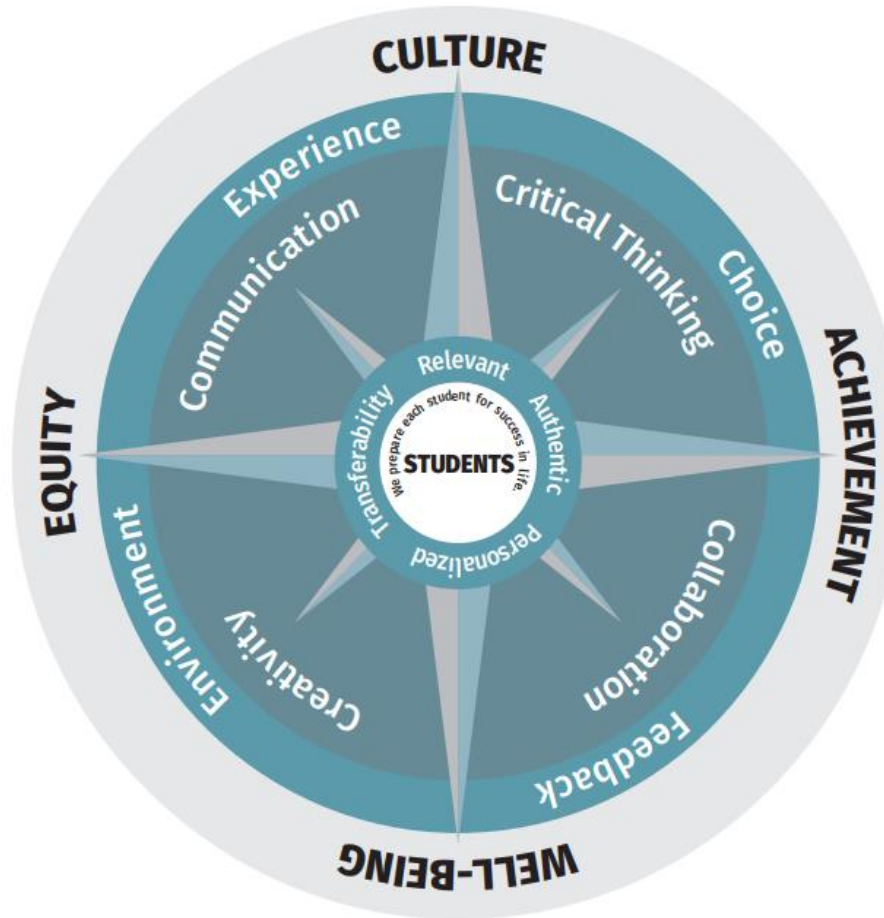

BOLD Ideas  
Redesigning High School

# Diploma PLUS



EXPLORE • IGNITE • EXPERIENCE





# Design & Plan Year

What Is Working Already?



# Design & Plan Year

What's Already Working? **283 Business Partners**



**Strong CTE Programs**



**Community-Based Instruction for  
Students with Disabilities**



**Collaborative Education Ecosystem within the  
Community**

# Design & Plan Year

What's Already Working? **6,982 College Hours Earned By  
The Class of 2019**



# Design & Plan Year

## What's Already Working? **MVA Attainment – Class of 2019**

SCHOOL	GRADUATES GRAND TOTAL	COLLEGE CREDIT MET	IRC MET	INTERNSHIP MET	CLIENT PROJECT MET	TOTAL MVAS EARNED	GRADS WHO DID NOT EARN AN MVA	NUMBER OF GRADS EARNING ONE OR MORE MVAs	% OF GRADS EARNING MVA
Lee's Summit High School	439	75	30	106	58	269	247	192	44%
Lee's Summit North High School	488	149	28	98	110	385	217	271	56%
Lee's Summit West High School	525	126	53	96	102	377	264	261	50%
District Total	1,452	350	111	300	270	1,031	728	724	50%

# Design Teams

81 Community and staff members participated in District and Building Teams

- Subgroups of students not earning at least one MVA
- District and site coordination of RWL efforts through career navigators (one-stop shop)
- Data tracking system and employer engagement platform



# Design Teams

Diploma Plus Ensures Talent Pipeline



work experiences



industry-recognized  
credentials



college credit



entrepreneurial  
experiences



# Design Teams

Education and Workforce Ecosystem



# BOLD Goals

Strategic Plans for Redesigning High Schools



LEE'S SUMMIT  
R-7 SCHOOLS  
*Learning for Life*





# Strategic Plan: Goal #1

## 50% of Graduates Earned MVAs In 2019

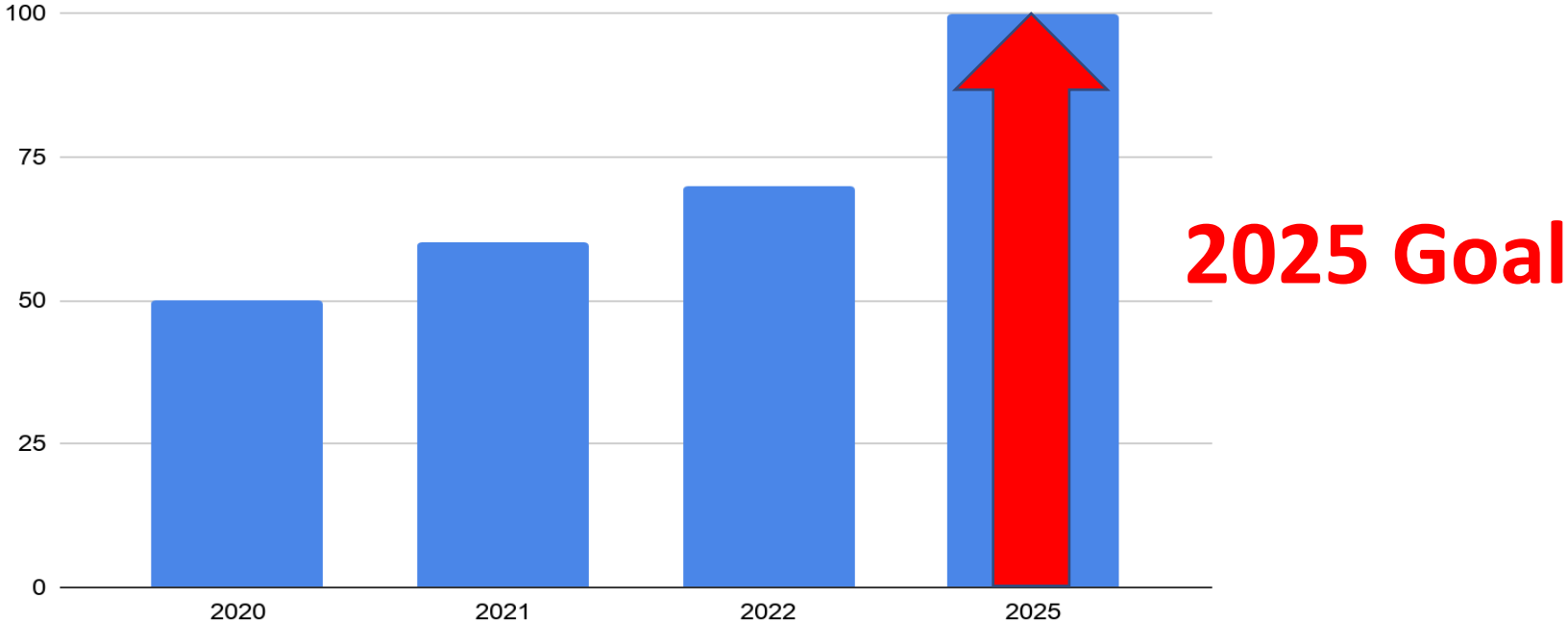

# Strategic Plan: Goal #2

credits  
grit wealth  
logistics  
gender schedules  
access  
inclusion  
ethnicity

# Strategic Plan: Subgroup Populations

Evaluating the impact of gender, wealth, ethnicity, and logistical barriers



Strategic Plan: Goal #3

EXPLORE

IGNITE

EXPERIENCE

# Tactics and Implementation Strategies



# Strategy

## Building New MVA Opportunities

### Advisory Councils

- Trades Association
- Health Care





# Infusion

## High Demand Industry Sectors



# Community Partnerships





# Strategy

## Course Design



# Infusion

Micro School at Lee's Summit High School





# New Experiences at Lee's Summit High School



# New Experiences at Lee's Summit West



Earn American History  
core credit through  
client projects that lead  
to internships with  
civic, cultural or  
museum employers



# New Experiences at Lee's Summit North



# New Experiences at Summit Ridge Academy



Individualized career mentoring with capstone project aligned with each student's interest and passion

New R7 Experiences at  
Summit Technology Academy  
& Lee's Summit West



# Accountability

## Through Instruction

- Inquiry-based instructional belief and framework
- Professional development alignment
- Elementary school career and passions-based exploration
- Middle school igniting of career and interest-based alignment
- Design thinking exploration based course

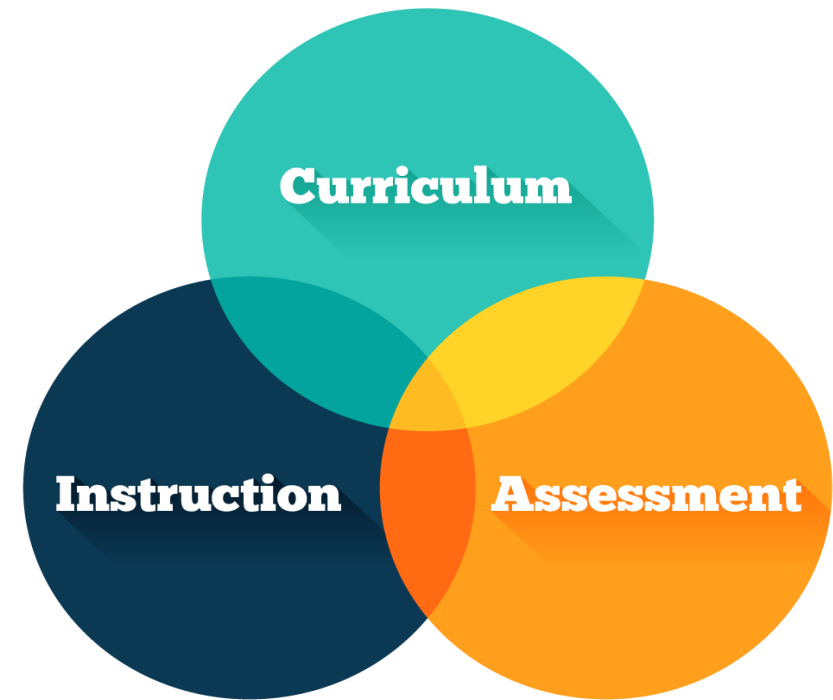



# Accountability

Expanded opportunities for virtual or traditional connections to explore and ignite passions

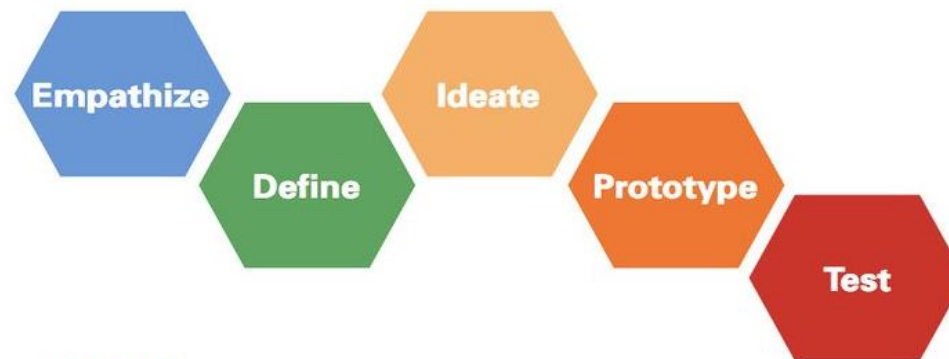

# Conditions

## Student Voice and Choice

- Students decide what they want to study
- Who they want to work with
- What outcomes they expect
- Where and when they do their work



# Conditions

## Community Connections



- Career navigators for community connections
- Track MVA data and formalized business and education partnerships in a data portal
- Externship opportunities for our teachers in alignment with our community through summer graduate courses

# Conditions

## Barrier Elimination

- Transportation
- Flexibility for graduation requirements flexibility
- Seat time and scheduling
- Space, time place barriers
- Reorganization of positions

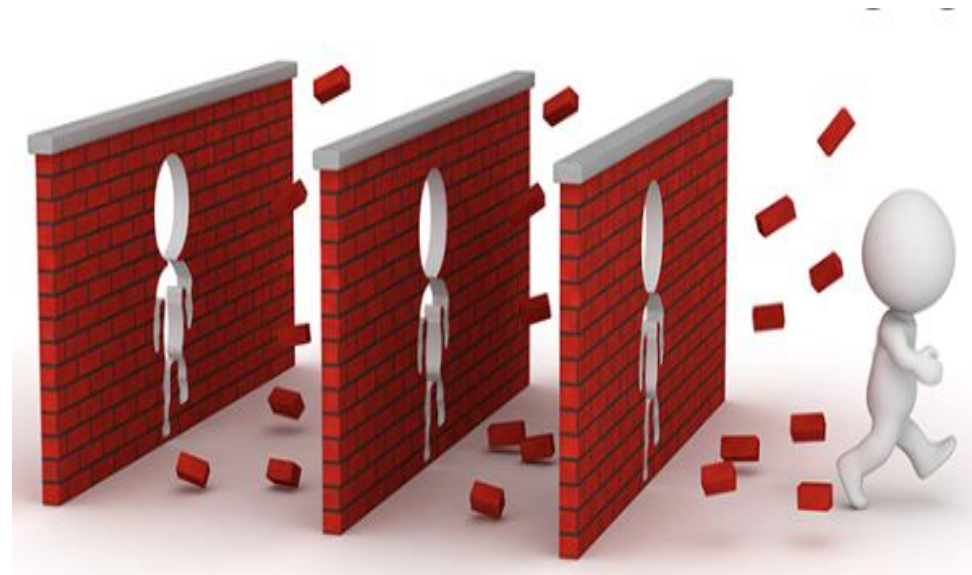

# Conditions

## Future-Ready Classrooms

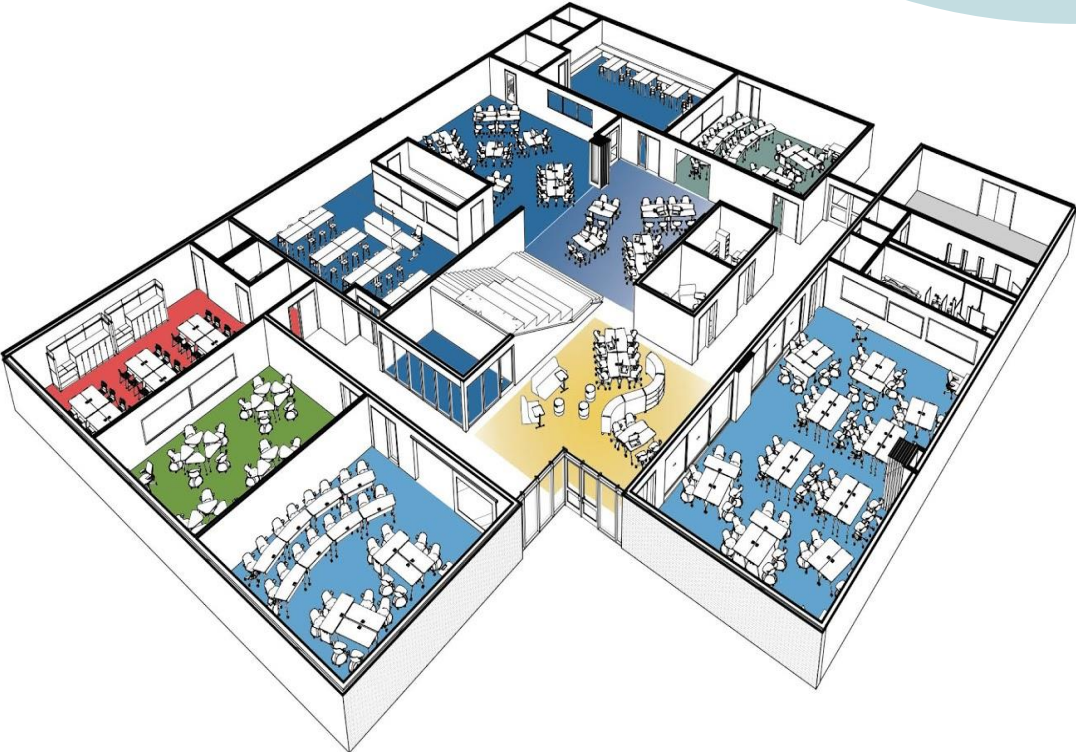



# Conditions

## Interactive Career Planning Guide



# The District's Ask....

Proposed Budget For The Three Year Strategic Plan



LEE'S SUMMIT  
R-7 SCHOOLS  
*Learning for Life*



# Budget: Year 1

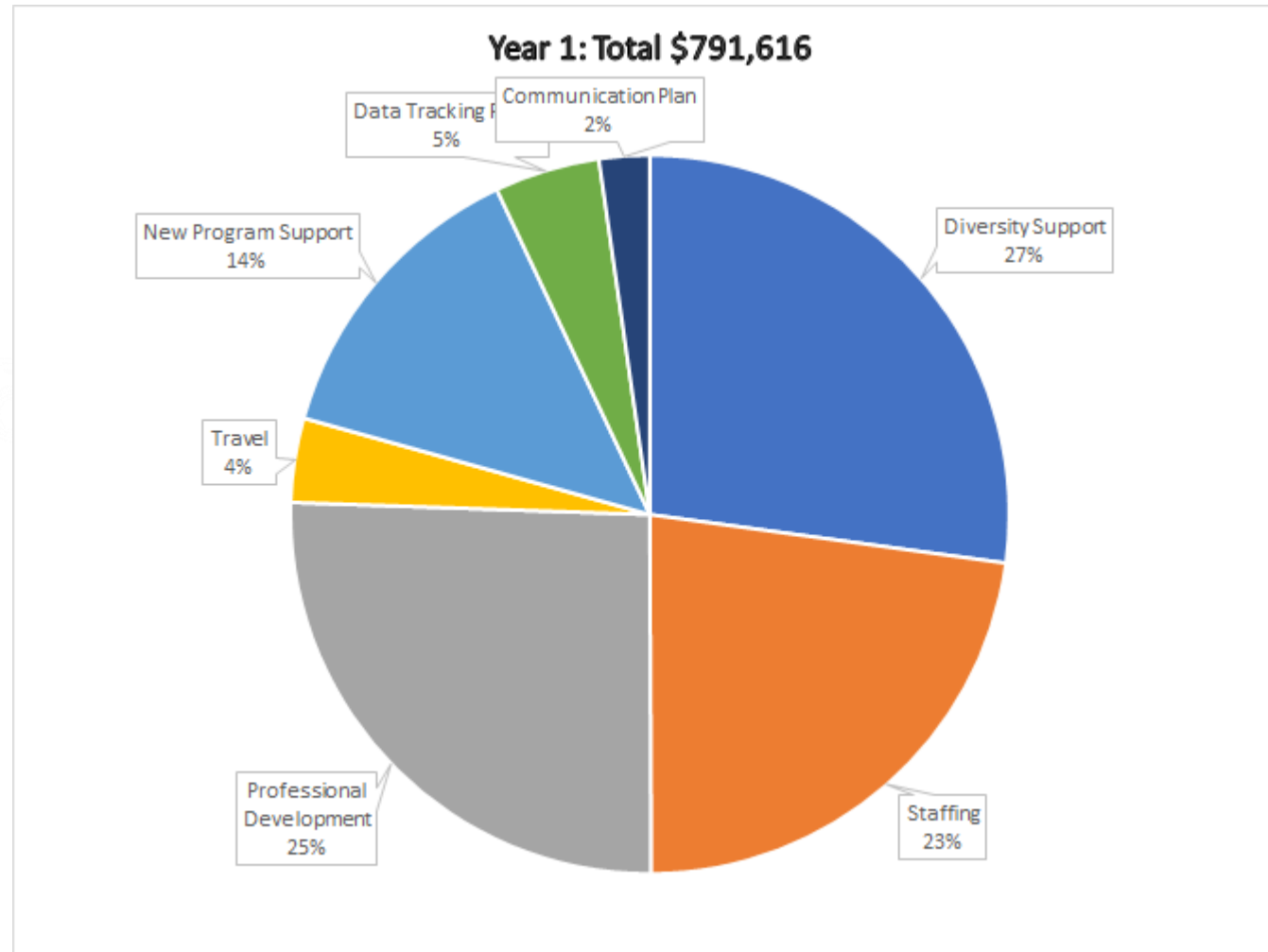



# Budget: Year 2

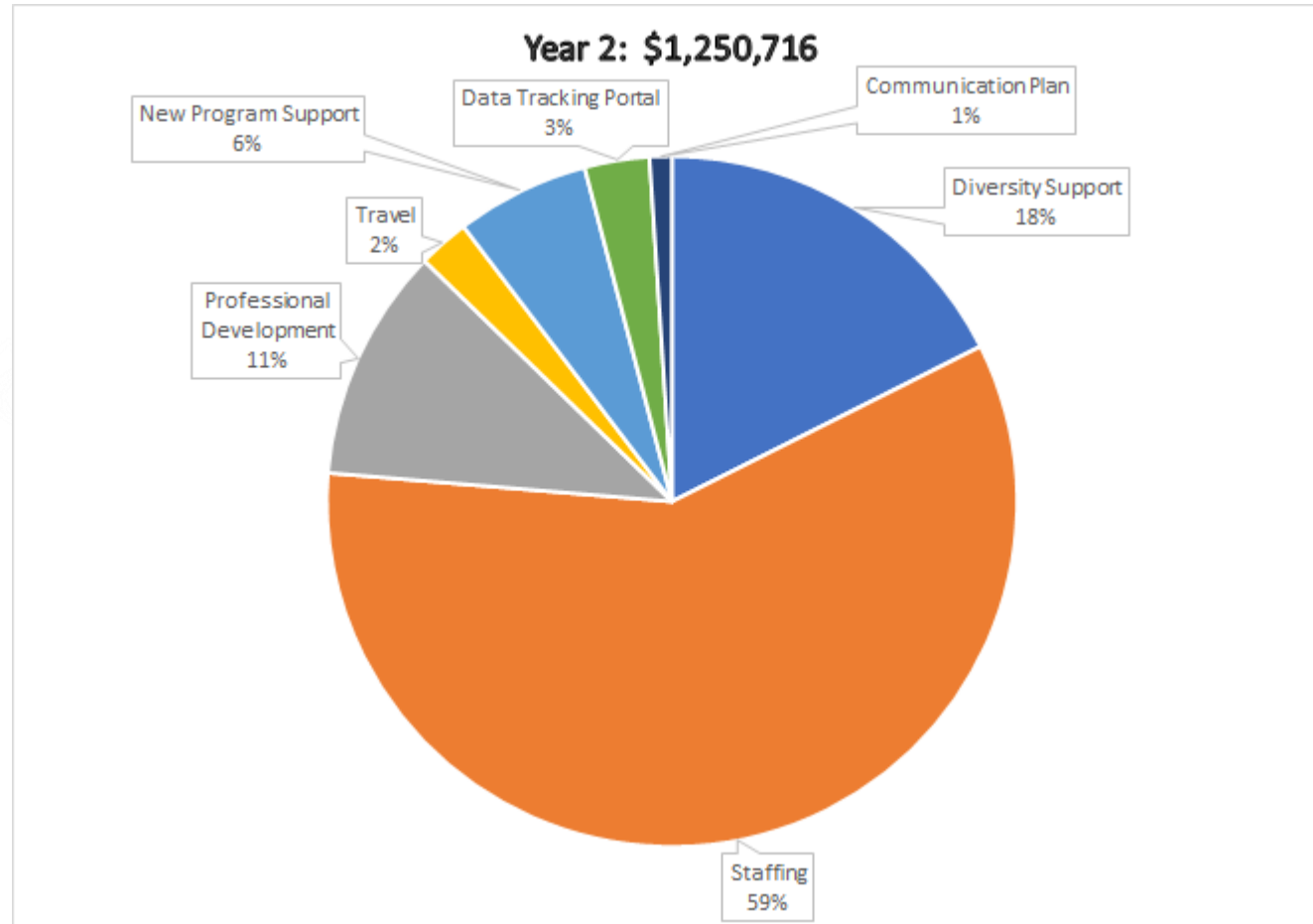

# Budget: Year 3

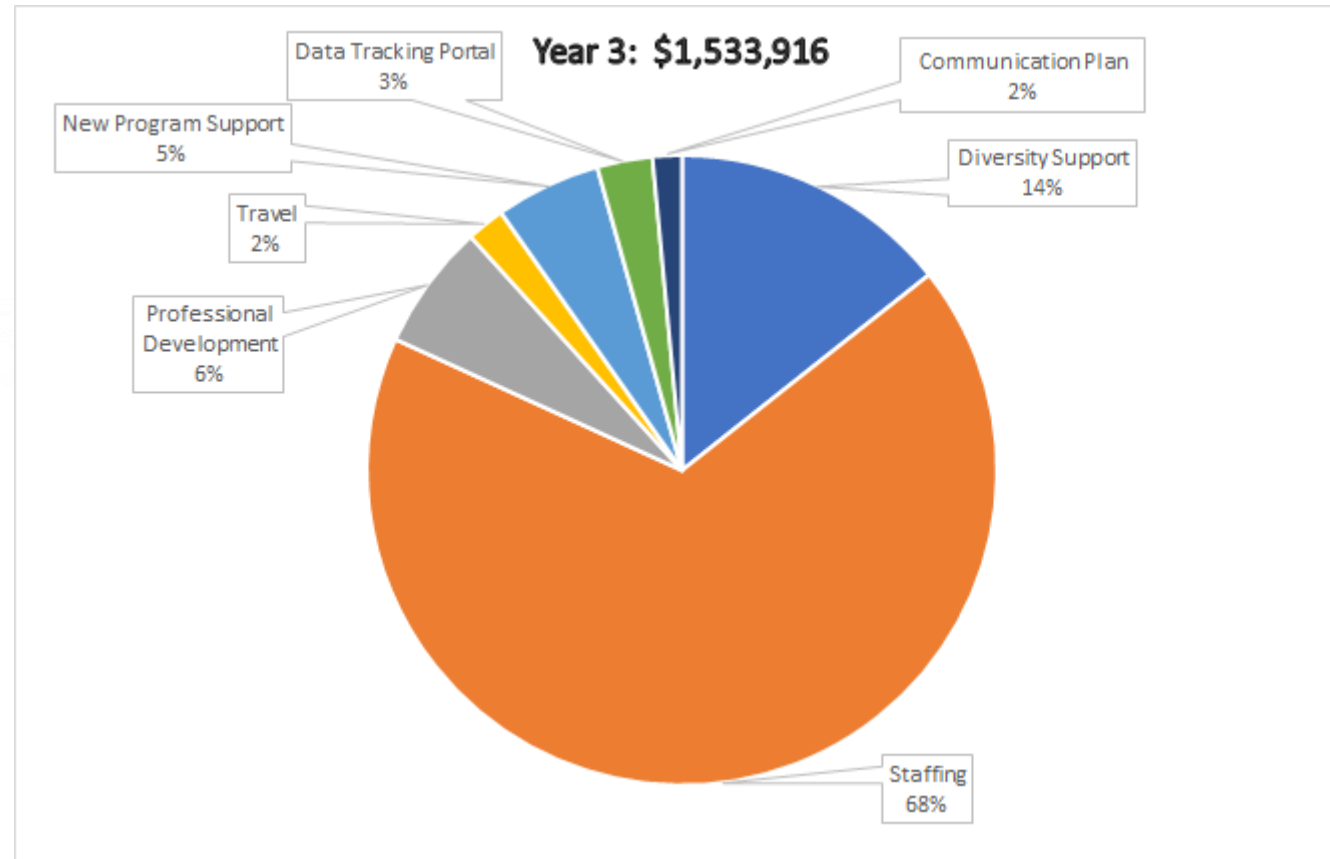

Sustainability

**Diploma**



**PLUS**

**EXPLORE • IGNITE • EXPERIENCE**

# BOLD FUTURE

LSR7 is reimagining the classroom experience. Focusing on strengths, needs, and interests will mean constructing a learning model unique to each student.

BOLD FUTURE

EXPLORE

IGNITE

EXPERIENCE





# Lee's Summit R-VII School District

[www.lsr7.org](http://www.lsr7.org)

[Video](#)